



HI-PRESS HYDRAULICS Ltd

T: +44 1663 735089
sales@hi-press.co.uk

TANGYE

Lightweight Jacks & Pumps

Product Catalogue

Powerful - 5 tonne capacity on head or toe

High lift - 178mm

Fast operation - 5.5mm lift per stroke

Stable - substantial base offers stability under load

Versatile - horizontal or vertical operation

Safe - positive stop feature prevents over stroking, pressure relief valve prevents overloading

Ease of operation - lifting/lowering controlled smoothly by operating lever, acceptable lever effort

Low clearance - 41mm

Reliable - jack hydraulics are totally enclosed

Robust construction – built with steel to withstand rough treatment.



Product Code	9501W	
Capacity	5 Tonnes	
Lever Weight	3.63 kgs	8 lbs
Jack Weight (inc oil)	18 kgs	40 lbs
Lift Per Stroke	5.5mm	0.21 ins
Max Handle Effort	45 kgf	99 lbf
Service Kit Number	995125	

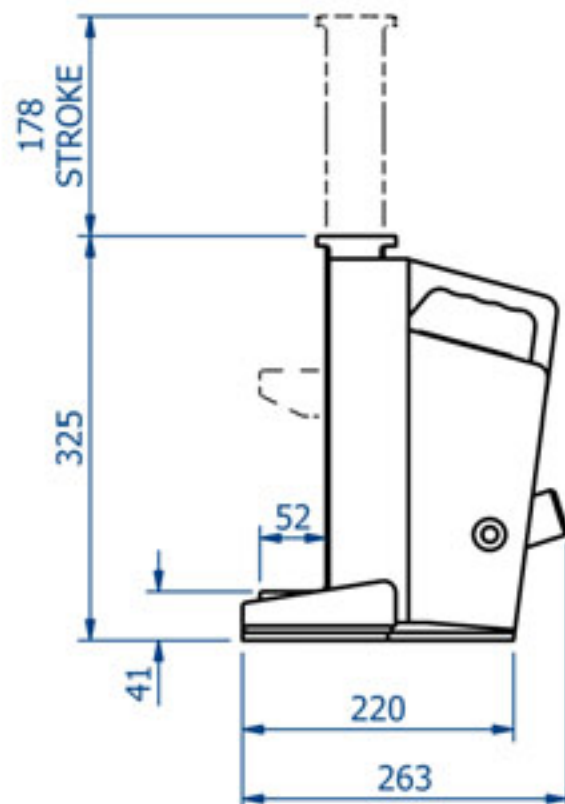
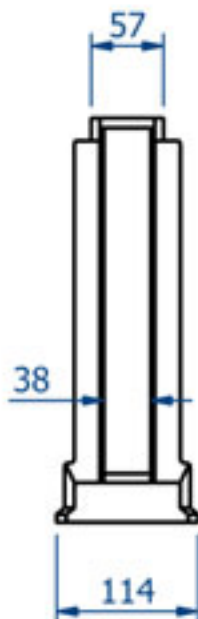

Hydramite

Powerful: 6.5 tonne, 10 tonne and 15 tonne capacity

Proven: thousands in use around the world

Well Engineered: servicing and repairs easily undertaken

Safe: relief valve prevents overloading

Compact and Lightweight ideal portable tool

Versatile: operates in any orientation, totally enclosed and suitable for use in dusty conditions

Easy to Operate : lift/lowering controlled easily by operating lever

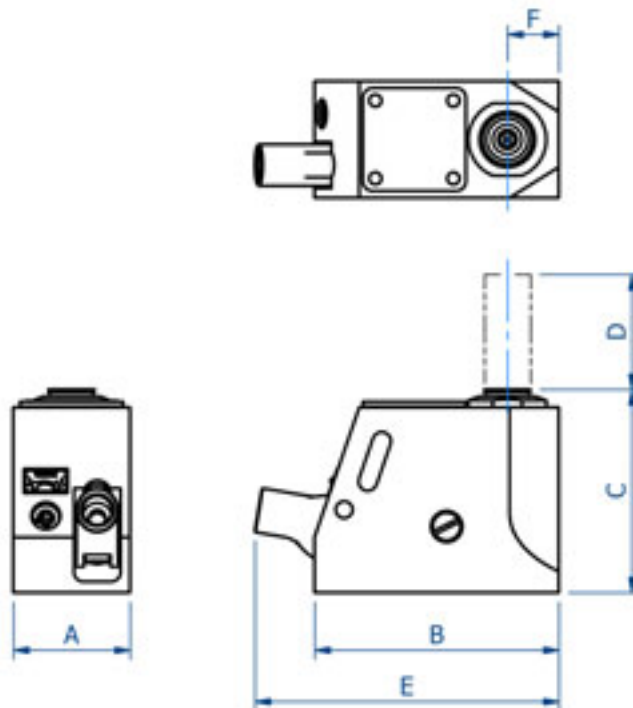

Product Code	8104H		1105002		1105003	
Capacity	6.5 tonne		10 tonne		15 tonne	
Lever Weight	1.7 kg	3.7 lbs	1.7kg	3.7 lbs	1.7 kg	3.7 lbs
Jack Weight	3.6 kg	8 lbs	6.3kg	13.9 lbs	10.0 kg	22 lbs
Dimensions	mm	ins	mm	ins	mm	ins
A - Base Width	76	2.99	76	3	92	3.62
B - Base Depth	158	6.22	171	6.73	197	7.75
C - Closed Height	140	5.51	182	7.17	230	9.06
D - Stroke	75	2.95	115	4.5	152	5.98
E - Max Depth	190	7.48	207	8.15	236	9.29
F - Centre Ram to Face	33.3	1.31	40	1.57	48	1.89
Ram Diameter	30	1.18	38	1.5	47.5	1.87
Service Kit Number	995052		995053		995054	



General Information

The Hydralite range is the most popular out of the Tangye jacks; the lightweight jacks are designed to lift, lower, manoeuvre and position heavy loads with maximum safety. The Hydralite range of jacks have the following features:

Portable: extensive use of high strength aluminium alloys has minimised jack weight for improved portability.

Reliable: All moving parts are totally enclosed and lubricated by hydraulic oil. Their long working life makes the Hydralite jacks the ideal choice for many rental operations.

Safe: **Overload Protection:** a high pressure relief valve prevents lifting of loads in excess of the jack's capacity while locking overloads applied to the ram.

Overstroke Protection: Hydralite jacks are fitted with a fail-safe positive stop mechanism which prevents overstroking of the ram by venting oil to the reservoir when the stroke limit is reached.

Load Sustaining: jack models can be fitted with a load retaining ring so that the load can be sustained for a significant time and there is no need to rely on the hydraulic fluid pressure.

Quality Assurance: every jack is serial numbered, fully tested and certified.

Minimum Operator Effort: full capacity is within the capability of one man. The short lever is lightweight and requires little space for operation.

Easy and Versatile Operation: operator control is provided by the hexagon key in the operating lever which smoothly controls the release valve. On most jacks the operating lever can be fitted in any one of the three positions in the quadrant to obtain the most suitable operating height. The jacks can be used vertically (on the base) or horizontally (on the face) due to the carefully positioned breather.

Low Clearance: claw models of most jacks are available for lifting loads with low ground clearance. All jacks used with a claw must be fitted with an extended base option. The load applied to the claw must not extend the maximum specification tables and marked on the claw. A claw should not be used on a screwed ram.

Wide Range: capacities from 20 tonne to 100 tonne with stroke options and claw and screwed ram features.

Easy to Maintain: the design of the jack makes inspection and component replacement uncomplicated. Main ram seal is changed by simply withdrawing the ram from the top of the jack. Refer to service instruction.

The Hydralite jacks have different stroke options:

Plain ram: For standard lifting applications.

Claw lift: claw models are available for lifting loads with low ground clearance. All claw jacks have an extended base.

Screwed ram: jacks with a screwed ram and load retaining ring should be selected when loads are to be sustained for a significant time.

6" Plain Ram

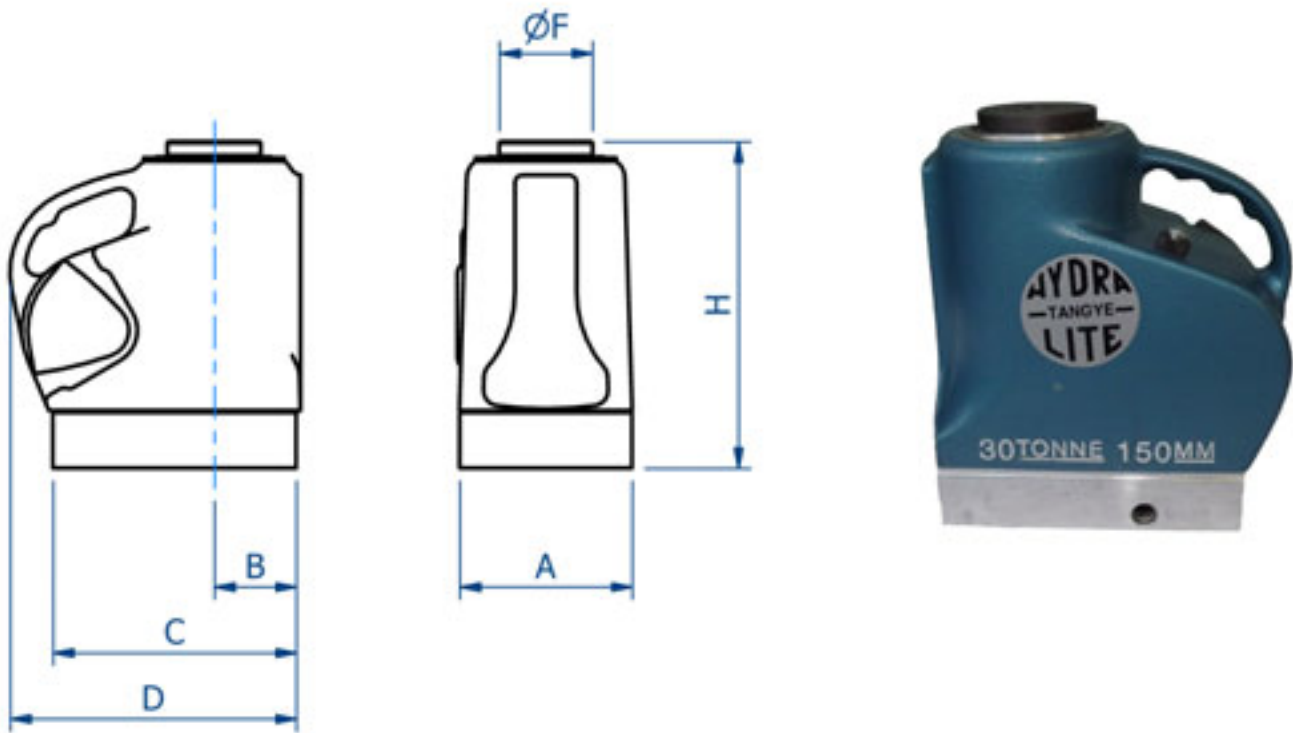

Product code	PS620		PS630		PS660	
Ram Capacity	20 Tonnes		30 Tonnes		60 Tonnes	
Lift Per Stroke	1.1 mm	0.042 ins	0.70 mm	0.026 ins	0.3 mm	0.013 ins
Weight of Jack	10.90 kgs	24 lbs	15.40 kgs	34 lbs	27.4 kgs	61 lbs
Working Pressure	682 Bars	9,900 PSI	644 Bars	9,350 PSI	644 Bars	9,350 PSI
Effort on Lever (max)	54 kgs	120 lbs	52 kgs	115 lbs	52 kgs	115 lbs
Oil Capacity	0.64 Litres	1.13 Pints	0.88 Litres	1.5 Pints	1.71 Litres	3 Pints
Dimensions	mm	ins	mm	ins	mm	ins
A - Width	121	4.75	140	5.5	190	7.5
B - Centre Ram To Face	60	2.38	70	2.75	92	3.625
C - Base Length	178	7	197	7.75	251	9.875
D - Overall Depth	214	8.44	235	9.25	286	11.25
F - Ram Diameter	60	2.38	76	3	108	4.25
H - Closed Height	263	10.38	263	10.375	293	11.562
Stroke	152	6	152	6	152	6
Service Kit Number	133506		133511		133518	



6" Screwed Ram

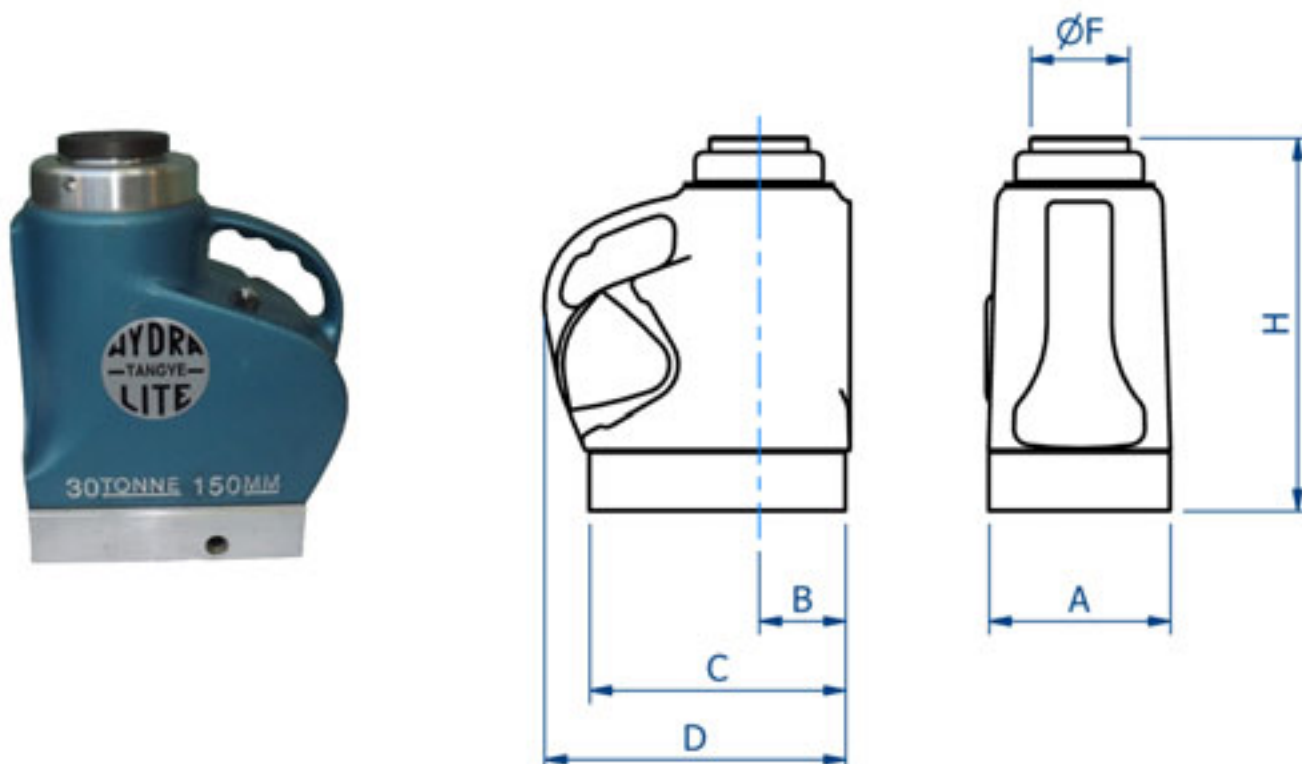

Product code	PS620S		PS630S		PS660S	
Ram Capacity	20 Tonnes		30 Tonnes		60 Tonnes	
Lift Per Stroke	1.1 mm	0.042 ins	0.70 mm	0.026 ins	0.3 mm	0.013 ins
Weight of Jack	10.90 kgs	24 lbs	15.40 kgs	34 lbs	27.4 kgs	61 lbs
Working Pressure	682 Bars	9,900 PSI	644 Bars	9,350 PSI	644 Bars	9,350 PSI
Effort on Lever (max)	54 kgs	120 lbs	52 kgs	115 lbs	52 kgs	115 lbs
Oil Capacity	0.64 Litres	1.13 Pints	0.88 Litres	1.5 Pints	1.71 Litres	3 Pints
Dimensions	mm	ins	mm	ins	mm	ins
A - Width	121	4.75	140	5.5	190	7.5
B - Centre Ram To Face	60	2.38	70	2.75	92	3.625
C - Base Length	178	7	197	7.75	251	9.875
D - Overall Depth	214	8.44	235	9.25	286	11.25
F - Ram Diameter	60	2.38	76	3	108	4.25
H - Closed Height	289	11.38	292	11.5	330	13
Stroke	152	6	152	6	152	6
Service Kit Number	133930		133932		133935	

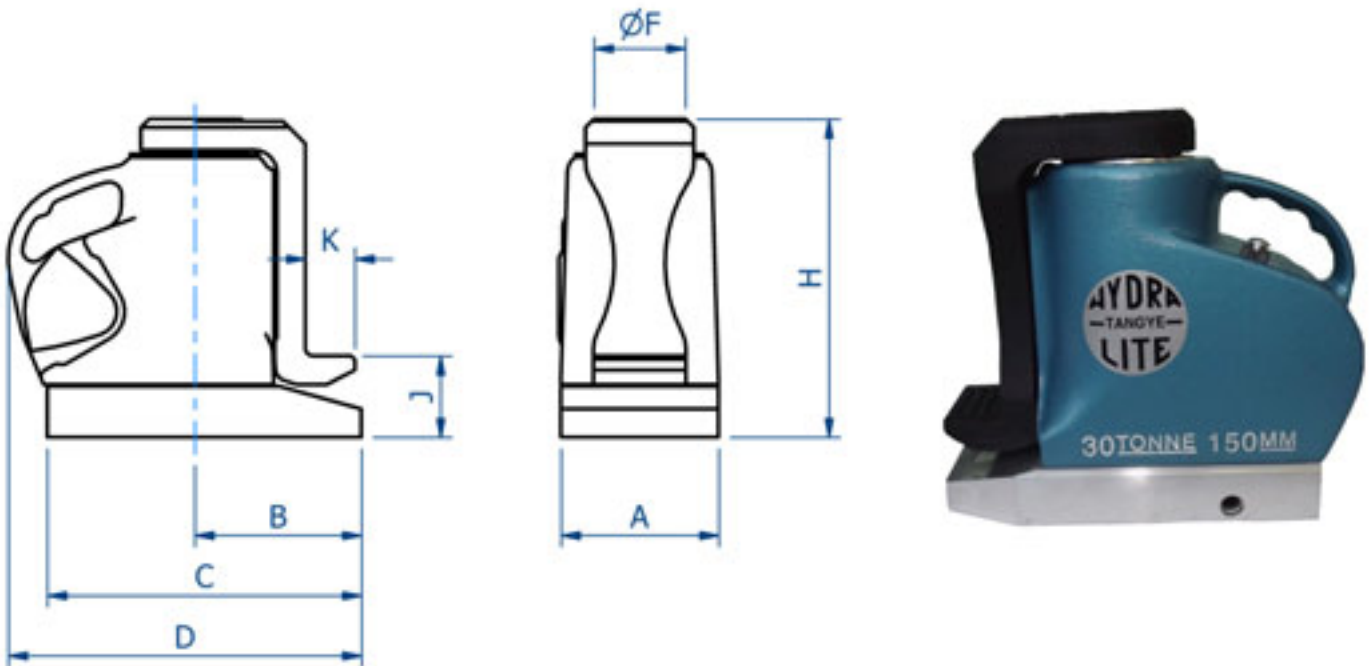

Product code	PS620C		PS630C		PS660C	
Ram Capacity	20 Tonnes		30 Tonnes		60 Tonnes	
Claw Capacity	8 Tonnes		12 Tonnes		24 Tonnes	
Lift Per Stroke	1.1 mm	0.042 ins	0.70 mm	0.026 ins	0.3 mm	0.013 ins
Weight of Jack	10.90 kgs	24 lbs	15.40 kgs	34 lbs	27.4 kgs	61 lbs
Weight of Claw	3.6 kgs	8 lbs	4.90 kgs	11 lbs	15.7 kgs	34.5 lbs
Working Pressure	682 Bars	9,900 PSI	644 Bars	9,350 PSI	644 Bars	9,350 PSI
Effort on Lever (max)	54 kgs	120 lbs	52 kgs	115 lbs	52 kgs	115 lbs
Oil Capacity	0.64 Litres	1.13 Pints	0.88 Litres	1.5 Pints	1.71 Litres	3 Pints
Dimensions	mm	ins	mm	ins	mm	ins
A - Width	121	4.75	140	5.5	190	7.5
B - Centre Ram To Claw	125	4.94	143	5.265	181	7.125
C - Base Length	246	9.69	273	10.75	339	13.375
D - Overall Depth	214	8.44	235	9.25	286	11.25
F - Ram Diameter	60	2.38	76	3	108	4.25
H - Closed Height	276	10.88	281	11.062	327	12.875
J - Base to Claw	67	2.63	73	2.875	73	2.875
K - Claw Depth	41	1.61	45	1.77	48	1.89
Stroke	152	6	152	6	152	6
Service Kit Number	133506		133511		133518	



12" Plain Ram

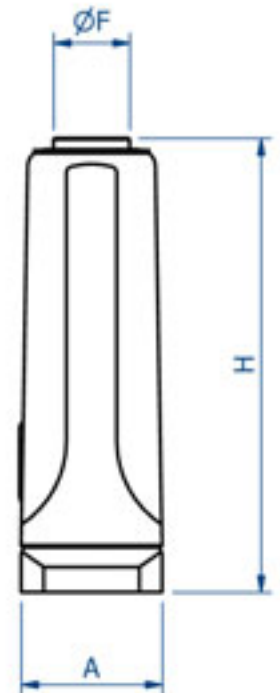

Product code	PS1220		PS1230		PS1260	
Ram Capacity	20 Tonnes		30 Tonnes		60 Tonnes	
Lift Per Stroke	1.1 mm	0.042 ins	0.70 mm	0.026 ins	0.3 mm	0.013 ins
Weight of Jack	16.7 kgs	37 lbs	23.40 kgs	52 lbs	43.7 kgs	97 lbs
Working Pressure	682 Bars	9,900 PSI	644 Bars	9,350 PSI	644 Bars	9,350 PSI
Effort on Lever (max)	54 kgs	120 lbs	52 kgs	115 lbs	52 kgs	115 lbs
Oil Capacity	1.14 Litres	2 Pints	1.71 Litres	3 Pints	2.84 Litres	5 Pints
Dimensions	mm	ins	mm	ins	mm	ins
A - Width	121	4.75	140	5.5	190	7.5
B - Centre Ram To Face	60	2.38	70	2.75	92	3.625
C - Base Length	246	9.69	273	10.75	339	13.375
D - Overall Depth	289	11.38	311	12.25	384	15.125
F - Ram Diameter	60	2.38	76	3	108	4.25
H - Closed Height	438	17.25	451	17.75	500	19.687
Stroke	305	12	305	12	305	12
Service Kit Number	133506		133511		133518	

12" Screwed Ram

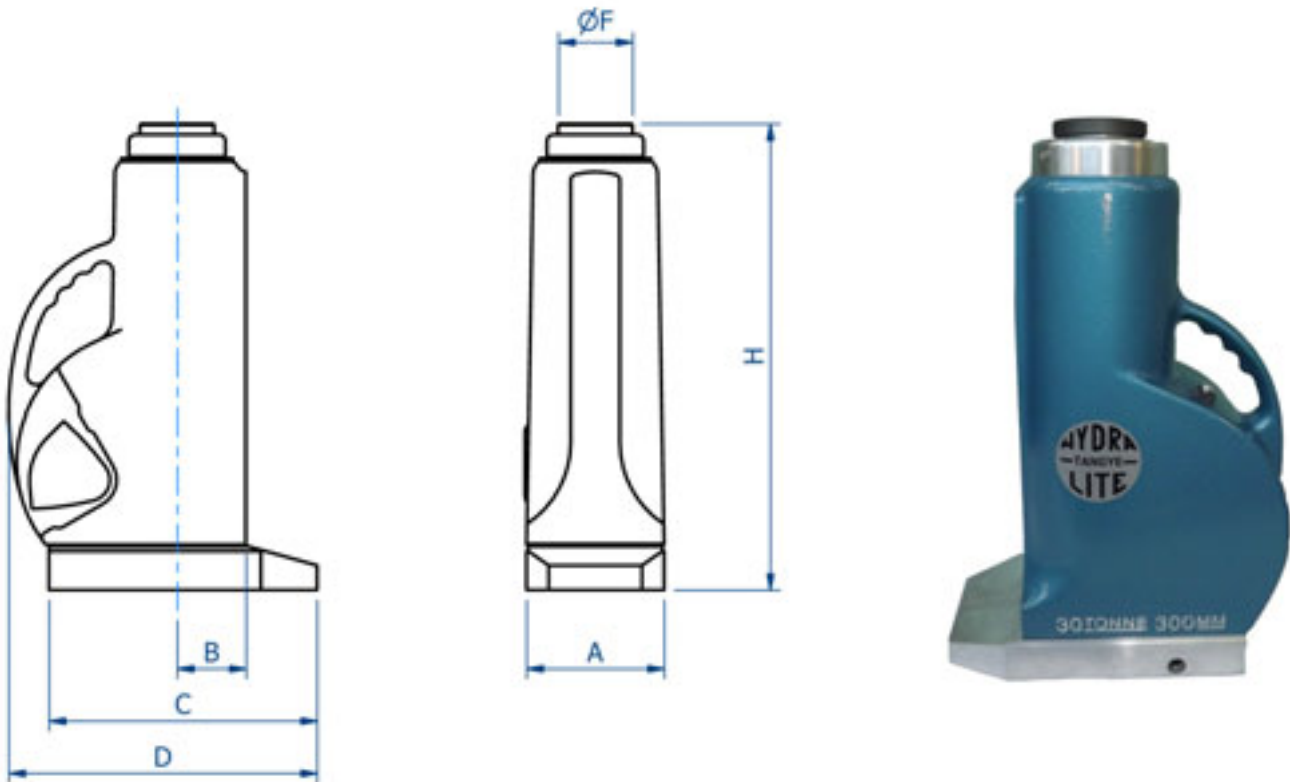

Product code	PS1220S		PS1230S		PS1260S	
Ram Capacity	20 Tonnes		30 Tonnes		60 Tonnes	
Lift Per Stroke	1.1 mm	0.042 ins	0.70 mm	0.026 ins	0.3 mm	0.013 ins
Weight of Jack	16.7 kgs	37 lbs	23.40 kgs	52 lbs	43.7 kgs	97 lbs
Working Pressure	682 Bars	9,900 PSI	644 Bars	9,350 PSI	644 Bars	9,350 PSI
Effort on Lever (max)	54 kgs	120 lbs	52 kgs	115 lbs	52 kgs	115 lbs
Oil Capacity	1.14 Litres	2 Pints	1.71 Litres	3 Pints	2.84 Litres	5 Pints
Dimensions	mm	ins	mm	ins	mm	ins
A - Width	121	4.75	140	5.5	190	7.5
B - Centre Ram To Face	60	2.38	70	2.75	92	3.625
C - Base Length	246	9.69	273	10.75	339	13.375
D - Overall Depth	289	11.38	311	12.25	384	15.125
F - Ram Diameter	60	2.38	76	3	108	4.25
H - Closed Height	464	18.25	479	18.875	536	21.125
Stroke	305	12	305	12	305	12
Service Kit Number	133930		133932		133935	



12" Claw

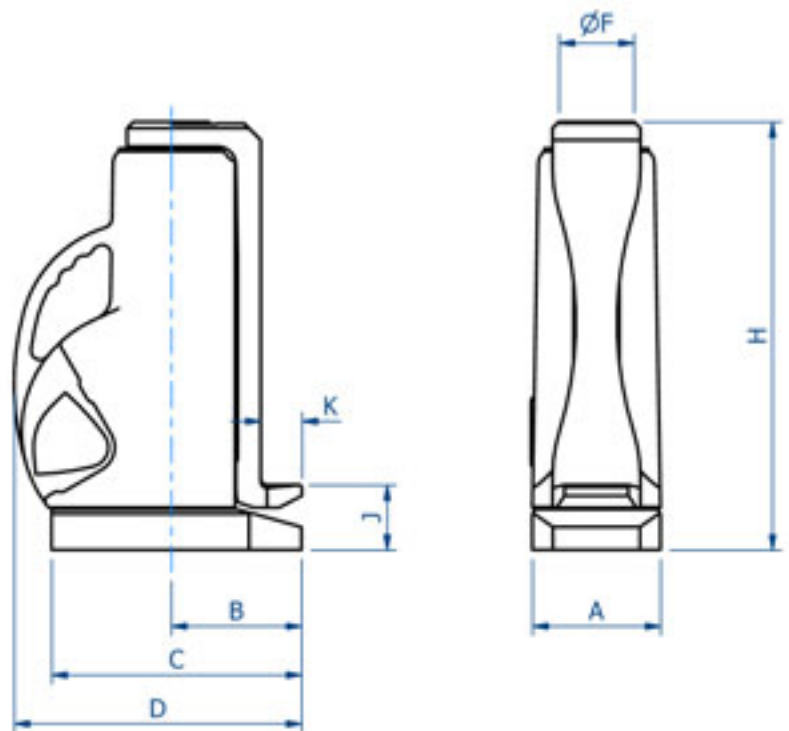

Product code	PS1220C		PS1230C		PS1260C	
Ram Capacity	20 Tonnes		30 Tonnes		60 Tonnes	
Claw Capacity	8 Tonnes		12 Tonnes		24 Tonnes	
Lift Per Stroke	1.1 mm	0.042 ins	0.7 mm	0.026 ins	0.3 mm	0.013 ins
Weight of Jack	16.7 kgs	37 lbs	23.4 kgs	52 lbs	43.7 kgs	97 lbs
Weight of Claw	5.5 kgs	12 lbs	7.6 kgs	17 lbs	21.2 kgs	47 lbs
Working Pressure	682 Bars	9,900 PSI	644 Bars	9,350 PSI	644 Bars	9,350 PSI
Effort on Lever (max)	54 kgs	120 lbs	52 kgs	115 lbs	52 kgs	115 lbs
Oil Capacity	1.14 Litres	2 Pints	1.71 Litres	3 Pints	2.84 Litres	5 Pints
Dimensions	mm	ins	mm	ins	mm	ins
A - Width	121	4.75	140	5.5	190	7.5
B - Centre Ram To Claw	125	4.94	143	5.625	181	7.125
C - Base Length	246	9.69	273	10.75	339	13.375
D - Overall Depth	289	11.38	311	12.25	384	15.125
F - Ram Diameter	60	2.38	76	3	108	4.25
H - Closed Height	452	17.88	470	18.5	533	21
J - Base to Claw	67	2.63	73	2.875	73	2.875
K - Claw Depth	41	1.61	45	1.77	48	1.89
Stroke	305	12	305	12	305	12
Service Kit Number	133506		133511		133518	

100 Tonne

The 100 tonne Hydralite is powered by two internal pumps, the low pressure, fast-speed plunger moves the ram out quickly, up to a load of about 8 tonnes on the ram, before transfer to the high pressure plunger becomes necessary. The lift of ram per stroke of lever is 1.1mm on low pressure and 0.1mm on high pressure.

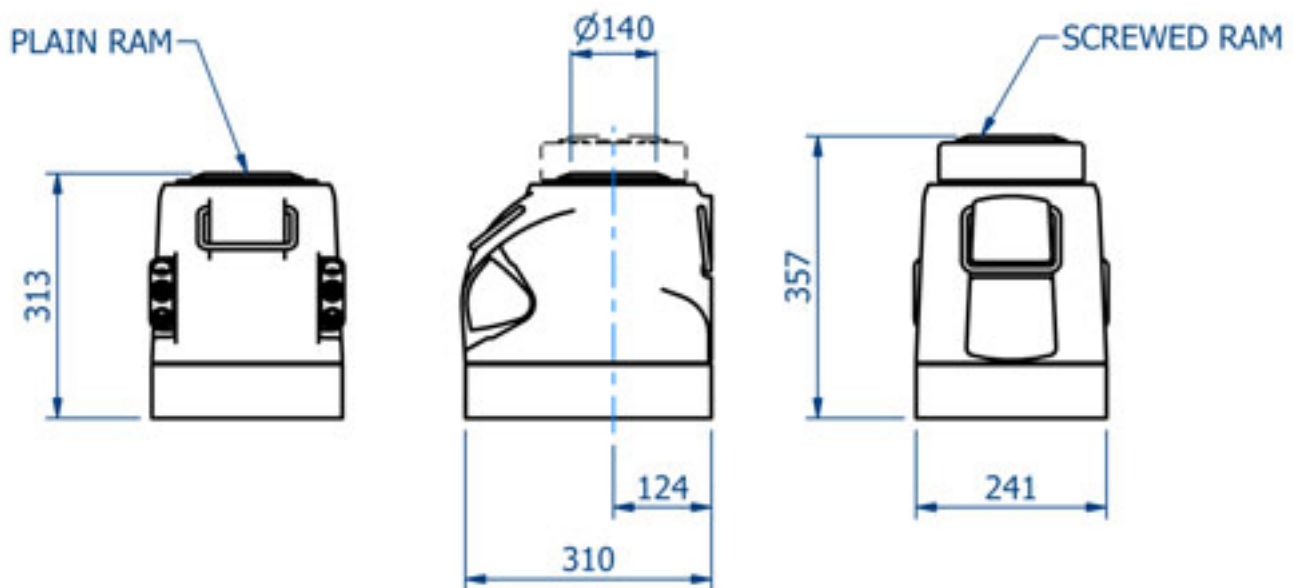

Capacity	100 Tonne			
Product code	P6100		P6100S	
Ram Type	Plain		Screwed	
Weight	49 kgs	108 lbs	53 kgs	117 lbf
Working Pressure	640 Bars	9280 lbf/in ²	640 Bars	9280
Effort on Lever	778 N	175 lbf	778 N	175 lbf
Lift/Stroke High	0.1 mm	0.005 ins	0.1 mm	0.005 ins
Lift/Stroke Low	1.1 mm	0.043 ins	1.1 mm	0.043 ins
Oil Capacity	2.23 Litres	3.92 Pints	2.3 Litres	4.05 Pints
Dimensions	mm	Ins	mm	Ins
Stroke	152	6	152	6
Width	241	9.48	241	9.48
Depth	310	12.2	310	12.2
Closed Height	313	12.32	357	14.05
Centre Ram To Face	124	4.88	124	4.88
ø Diameter	108	4.25	108	4.25
Service Kit Number	995058			



General Information

The Hydrapak pumps have the following characteristics:

Fast: two speeds operation gives rapid prefill or no load approach

Compact: small in size but produces up to 700 bar pressure

Portable: lightweight aluminium keeps weight down to 4.5kg

Safe: optional factory fitted relief valve prevents over pressurisation

Range: six models ranging from 110 bar to 700 bar are available

High Flow: Interchangeable plungers allows selection of optimum pressure/flow characteristics.

Fluid Compatibility

The standard pump is supplied with nitrile rubber seals suitable for use with mineral oils, water, oil/water emulsions, paraffin and glycerine. The pump body should not be left in contact with water for prolonged periods. After using salt water in the pump, thoroughly flush clean.

Ethylene Propylene (E.P) seals are available to order for applications using phosphate ester based hydraulic fluids and vegetable based brake fluid. E.P seals are compatible with skydrol 500B and LD4. please contact our technical department if in doubt.

Pressure Relief Valve

A factory set pressure relief valve may be fitted to the pump and set at any specified pressure between 56 and 700 bar. We strongly recommend that all hydrapaks are fitted with a pressure relief valve to prevent overloading and exceeding maximum safe working pressures.

Gauges

100mm gauges and a fixing kit are available for horizontal mounting of a pressure gauge above the top face of the pump. For pumps with a double acting valve a fixing kit for vertical mounting is supplied. Six standard gauges corresponding to the six standard pressure ratings are available.

Double Acting Valve

A three position four port valve for control of double acting cylinders is offered as a factory fitted option. Valve outlets are tapped 3/8 NPT. There is no release valve assembly fitted to the pump body and, although internal leakage of the valve is minimal, isolation valves should be fitted to circuits where pressure must be sustained

Interchangeable Plungers

High/low pressure plunger kits can be supplied to change the pressure/flow characteristics to any of the six standards.



Hydrapak

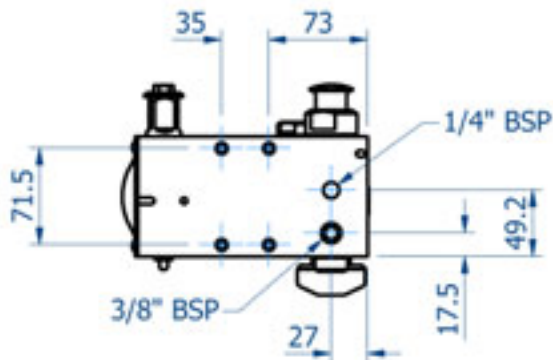
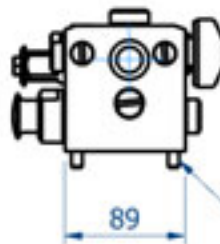
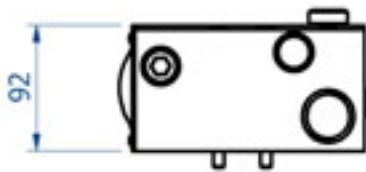
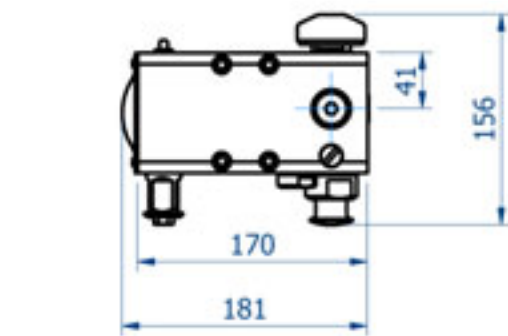

M8 x 90 SCREW
4 PLACES

Order Code

e.g. PH011RG = 10,000 psi pump on 4.5 litre cistern with relief valve and gauge

1st Character - P = Pump

2nd Character - H = Hydrapak

3rd Character - O = Basic Pump

- V = Pump with double acting valve

4th Character - 1 to 6 = Max Pressure (see table below)

5th Character - 1 to 8 = Tank Capacity (with/without skid/frame)

6th Character - R = Relief Valve Fitted

- O = Relief Valve Omitted

7th Character - G = Gauge Fitted

- O = Gauge Omitted

Model	PH06000		PH05000		PH04000		PH03000		PH02000		PH01000	
	BAR	PSI	BAR	PSI	BAR	PSI	BAR	PSI	BAR	PSI	BAR	PSI
Max Pressure	110	1600	172	2500	310	4500	448	6500	552	8000	700	10000
H.P Stage												
Max Pressure	52	750	52	750	52	750	52	750	52	750	52	750
LP Stage												
	CC	CU INS	CC	CU INS	CC	CU INS	CC	CU INS	CC	CU INS	CC	CU INS
Displacement per Stroke	22.61	1.38	14.47	0.883	8.13	0.496	5.65	0.345	4.57	0.279	3.62	0.221
H.P Stage												
Displacement per Stroke	50.8	3.1	50.8	3.1	50.8	3.1	50.8	3.1	50.8	3.1	50.8	3.1
LP Stage												
Service Kit Number	133947		133948		133949		133950		133951		133952	
EP Seal Kit Number	134118		134119		134120		134121		134122		134123	



Tanks

Tanks are available with all our Hydrapak pumps. The tanks are of aluminium construction.

A range of standard tanks to satisfy most requirements are listed in the table below.

The Hydrapak can also be fitted to custom build tanks.

Larger tanks are available upon request.

Frames and skids are available upon request.



Model	HPK4		HPK5	
Capacity	5 Litre		9 Litre	
Dimensions	mm	ins	mm	ins
A - Centres	114	4.49	165	6.49
B - Centres	247	9.72	317	12.48
C - Width	167	6.57	230	9.06
D - Depth	294	11.57	363	14.29
E - Height	163	6.41	215	8.46

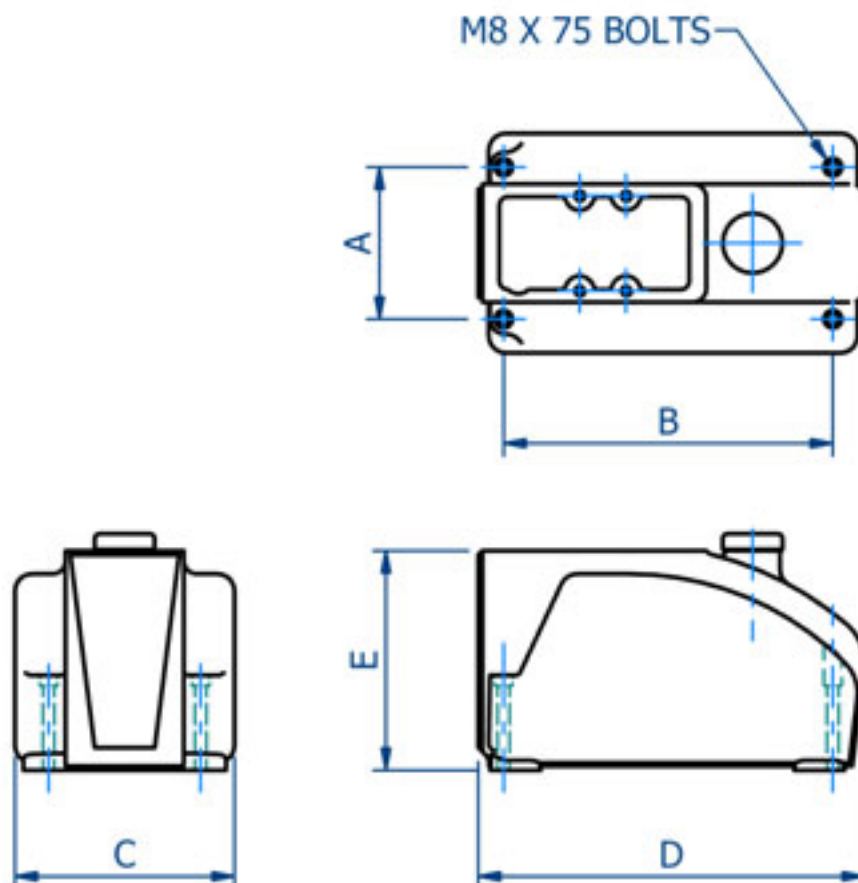



Allspeeds manufactures the following five brands along with providing engineering solutions for many different industries including rail, aviation, demolition, decommissioning, oil and gas and subsea.

WEBTOOL

Allspeeds Webtool division specialise in engineering and manufacturing powerful hydraulic wire rope and cable cutting tools, grippers, shackles and specialist subsea tools developed to meet the needs of users who demand high quality and total reliability.

Models include designs for use subsea by ROVs and surface applications in hostile environments.

All Webtool's are suitable for use subsea at depths of 3000m.

We also design, engineer and manufacture bespoke tooling to adhere to specifications and criteria requested. Many of our bespoke tools have become industry standard tools.



Allspeeds is now the UK's largest manufacturer of sub-surface pumps and is known throughout the oil industry for top quality reliable products at competitive prices along with excellent customer service and support.

Millingford manufacture, supply and service the full range of subsurface pumps and fittings covered by the API specification 11AX in addition to a range of special pumps which have been developed to satisfy a wide variety of oil well conditions.

A highly trained, experienced and skilled workforce produce all Millingford items in our own manufacturing facility here in the UK



Tangye's hydraulic jacks are in daily use throughout the world working efficiently for customers who require jacks for a variety of applications from supporting bridges to lifting the nose end of F16 fighter planes.

Tangye jacks can lift up to 100 Tonnes and are used in many industries such as construction, industrial, automotive, mining, railroad, manufacturing and many more

Tangye also offers a range of pumps and cylinders to meet your requirements. Servicing is available for all of our Tangye hydraulic jacks. All Tangye hydraulic jacks are manufactured by Allspeeds here in Accrington, UK



Kopp Variators are mechanical variable speed drives or transmissions used to control speeds on industrial machinery. They are constant power torque converters with extremely accurate speed holding and resetability.

Modern technology demands the ability to change speeds frequently, whether by manual methods or automatic control systems. The Kopp Variator is ideally suited to these requirements, as the control mechanism is light, positive and extremely accurate. The Kopp Variator offers speed ranges from 11:1 variation and input powers 0.18kW to 25kW. The Kopp series ranges from Variators utilising a straightforward free shaft ball to the sophisticated cone type K Variator that incorporates closed loop control servo systems.



Back in the mid 1800's John Blake created a water powered pump that was capable of moving water from one place to another using only the energy contained in a flowing stream or river.

Today, the Hydrum is still as effective as ever and is capable of supplying water to remote houses or communities, provide water for livestock and allow irrigation of land or inaccessible areas.





HI-PRESS HYDRAULICS

- Hydraulic Equipment including Spares and Accessories
- Reconditioning & Servicing of Hydraulic Equipment on & off your premises
- Design and Manufacture of Hydraulic Tools and Equipment

HEAD OFFICE: HI-PRESS HYDRAULICS LTD

RIVERSIDE WORKS,
FORGE ROAD, WHALEY BRIDGE,
HIGH PEAK, SK23 7HY

N.Mullen
Director
Hi-Press Hydraulics Ltd

T: +44 1663 735089 - F: +44 1663 735090
sales@hi-press.co.uk

///TANGYE///

Lightweight Jacks & Pumps

