



▼ Shown: SQD-50-I



Lightweight Aluminium High-Power Wrench for Sockets or Allen Drives

- Very high torque-to-weight ratio
- High speed, double-acting operation
- High degree of rotation angle for increased productivity
- Never-jam mechanism
- High repeatability, with accuracy $\pm 3\%$
- Slim nose radius and 360° swivel hose connection allow easier positioning in confined areas
- Few moving parts means durability and low maintenance
- Push-button drive release; no tools needed to reverse square or Allen drives for tightening or loosening
- Storage case (included) protects from damage, water and dirt
- Lock-ring couplers are standard on all torque wrenches, pumps and hoses.



◀ Easy and reliable service in the field using Enerpac SQD-Series torque wrenches.



Swivel Hose Connection

All Enerpac torque wrenches feature a 360° swivel connection to allow easy access in all positions.



Twin 3,5:1 Safety Hoses

Use only Enerpac THC-700 series twin 3,5:1 safety hoses with SQD-Series double-acting wrenches to ensure the integrity of your system.

Length 6 m, 2 hoses	THC-7062
Length 12 m, 2 hoses	THC-7122



Optional Allen Drives

Expanded versatility with a wide range of metric and imperial Allen drives.





HI-PRESS HYDRAULICS Ltd

Double-Acting, Square Drive Hydraulic Wrenches

ENERPAC
POWERFUL SOLUTIONS. GLOBAL FORCE.



▲ All wrenches come standard with swivel coupler, square drive and reaction arm.

SQD Series



Maximum Torque:
27.000 Nm

Square Drive Range:
3/4 - 2 1/2 inch

Maximum Operating Pressure:
800 bar



Use only heavy-duty Impact Sockets for power driven torquing equipment, according to ISO 2725 and ISO 1174; DIN 3129 and DIN 3121 or ASME-B107.2/1995.

Page: **10**



Torque Wrench Pumps and Hoses

Enerpac system matched air and electric torque wrench pumps provide control to operate hydraulic torque wrenches.

Page: **38**



Hexagon Bolt and Nut Sizes

See the table for hexagon sizes of bolts, nuts and related thread diameters.

Page: **78**

TORQUE WRENCH SELECTION (based on socket size range)

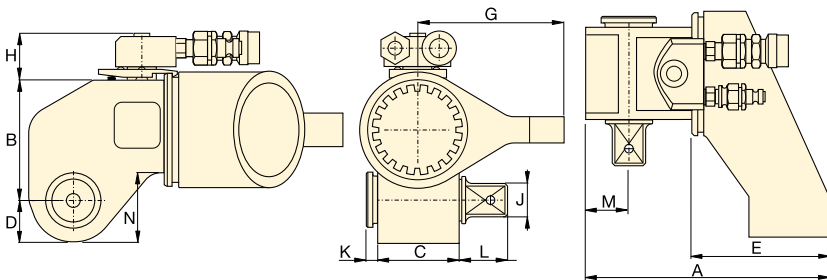
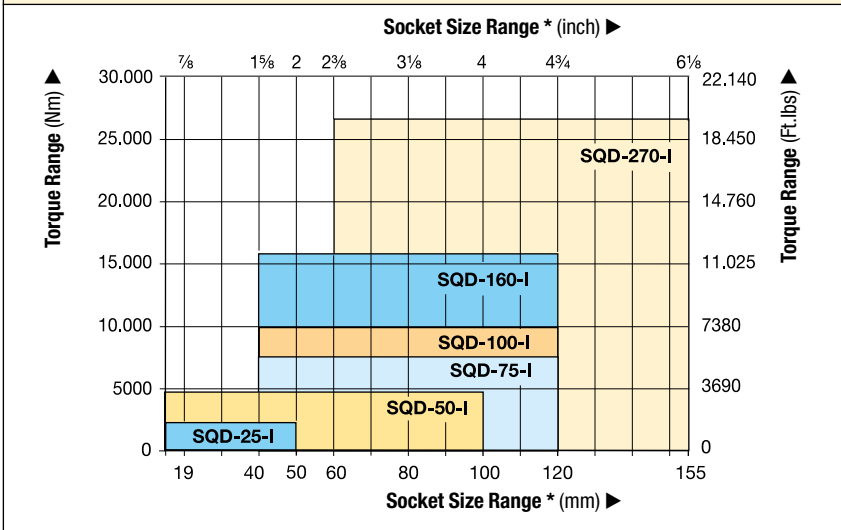

SELECTION CHART

Square Drive Size (inch)	Maximum Torque @ 800 bar		Torque Wrench Model Number	Dimensions (mm)											Weight (including reaction arm and square drive) (kg)	
	(Nm)	(Ft.lbs)		A	B	C	D	E	G	H	J	K	L	M		N
3/4	2350	1735	SQD-25-I	167	72	53	24	108	95	35	3/4	6	28	27	36	2,5
1	4800	3550	SQD-50-I	204	92	68	31	135	115	35	1	15	33	34	52	4,3
1 1/2	7560	5570	SQD-75-I	226	107	76	36	153	122	35	1 1/2	12	43	39	64	6,7
1 1/2	10.000	7360	SQD-100-I	253	115	84	39	164	130	35	1 1/2	13	39	43	68	8,0
1 1/2	16.000	11.835	SQD-160-I	272	134	100	48	178	150	50	1 1/2	11	45	54	81	12,0
2 1/2	27.000	19.875	SQD-270-I	342	164	119	59	218	200	50	2 1/2	18	76	63	99	24,5

* See page 10 for BSH-series Heavy-Duty Impact Sockets.



HI-PRESS HYDRAULICS LTD
RIVERSIDE WORKS,
FORGE ROAD, WHALEY BRIDGE,
HIGH PEAK, SK23 7HY

T: 01663 735089 - F: 01663 735090
sales@hi-press.co.uk

HI-PRESS HYDRAULICS LTD
UNIT 2, HALL HOUSE IND EST,
NEW HUTTON, KENDAL,
CUMBRIA, LA8 0AH

T: 01539 734005 - F: 01539 734006
cumbria@hi-press.co.uk





HI-PRESS HYDRAULICS Ltd

SQD-Series, Imperial Allen Drives

ENERPAC
 POWERFUL SOLUTIONS. GLOBAL FORCE.

▼ SELECTION CHART

TORQUE WRENCH		OPTIONAL ALLEN DRIVES, IMPERIAL			REACTION ARM FOR ALLEN DRIVE
Model Number (max. capacity)	Nose Radius D (mm)	Hexagon Size (inch)	Maximum Torque (Nm)	Model Number	Model Number
SQD-25-I (2350 Nm)	24	1/2	530	25A-050	RAH-25
		5/8	1000	25A-063	
		3/4	1800	25A-075	
		7/8	2350	25A-088	
		1	2350	25A-100	
SQD-50-I (4800 Nm)	31	5/8	1000	50A-063	RAH-50
		3/4	1800	50A-075	
		7/8	2800	50A-088	
		1	4200	50A-100	
		1 1/8	4800	50A-113	
		1 1/4	4800	50A-125	
		-	-	-	
SQD-75-I (7560 Nm)	31	5/8	1000	75A-063	RAH-75
		3/4	1800	75A-075	
		7/8	2800	75A-088	
		1	4200	75A-100	
		1 1/8	5900	75A-113	
		1 1/4	7560	75A-125	
SQD-100-I (10.000 Nm)	39	7/8	2800	100A-088	RAH-100
		1	4200	100A-100	
		1 1/8	5900	100A-113	
		1 1/4	8500	100A-125	
		1 3/8	10.000	100A-138	
		1 1/2	10.000	100A-150	
SQD-160-I (16.000 Nm)	48	1 1/4	8500	160A-125	RAH-160
		1 3/8	10.500	160A-138	
		1 1/2	14.000	160A-150	
		1 5/8	16.000	160A-163	
		1 3/4	16.000	160A-175	
SQD-270-I (27.000 Nm)	59	1 1/2	14.000	270A-150	RAH-270
		1 5/8	18.000	270A-163	
		1 3/4	22.000	270A-175	
		1 7/8	27.000	270A-188	
		2	27.000	270A-200	
		2 1/4	27.000	270A-225	
		-	-	-	
		-	-	-	

For
SQD
Series



Maximum Torque at 800 bar:
27.000 Nm

Allen Drive Range:
1/2 - 2 1/4 inch

Nose Radius:
24 - 59 mm



Torque Wrench Pumps and Hoses

Enerpac system matched air and electric torque wrench pumps provide control to operate hydraulic torque wrenches.

Page: **38**



NS and NC-Series Nut Splitters

Remove rusted or corroded nuts easily with Enerpac Nut Cutters. Cuts hexagon nut sizes up to 130 mm.

Page: **63**



Hexagon Bolt and Nut Sizes

See the table for hexagon sizes of bolts, nuts and related thread diameters.

Page: **78**

▼ SQD-100-I with RAH-100 Reaction Arm and Allen drive used for loosening hexagon socket head cap screws.



HI-PRESS HYDRAULICS LTD
RIVERSIDE WORKS,
FORGE ROAD, WHALEY BRIDGE,
HIGH PEAK, SK23 7HY

T: 01663 735089 - F: 01663 735090
sales@hi-press.co.uk

HI-PRESS HYDRAULICS LTD
UNIT 2, HALL HOUSE IND EST,
NEW HUTTON, KENDAL,
CUMBRIA, LA8 0AH

T: 01539 734005 - F: 01539 734006
cumbria@hi-press.co.uk





HI-PRESS HYDRAULICS Ltd

SQD-Series, Metric Allen Drives

ENERPAC
 POWERFUL SOLUTIONS. GLOBAL FORCE.

▼ SELECTION CHART

TORQUE WRENCH		OPTIONAL ALLEN DRIVES, METRIC			REACTION ARM FOR ALLEN DRIVE
Model Number (max. capacity)	Nose Radius D (mm)	Hexagon Size (mm)	Maximum Torque (Nm)	Model Number	Model Number
SQD-25-I (2350 Nm)	24	14	750	25A-14	RAH-25
		17	1300	25A-17	
		19	1800	25A-19	
		22	2350	25A-22	
		24	2350	25A-24	
SQD-50-I (4800 Nm)	31	17	1300	50A-17	RAH-50
		19	1800	50A-19	
		22	2800	50A-22	
		24	3500	50A-24	
		27	4800	50A-27	
		30	4800	50A-30	
		32	4800	50A-32	
SQD-75-I (7560 Nm)	31	17	1300	75A-17	RAH-75
		19	1800	75A-19	
		22	2800	75A-22	
		24	3500	75A-24	
		27	5000	75A-27	
		30	7000	75A-30	
		32	7560	75A-32	
SQD-100-I (10.000 Nm)	39	22	2800	100A-22	RAH-100
		24	3500	100A-24	
		27	5000	100A-27	
		30	7000	100A-30	
		32	8500	100A-32	
		36	10.000	100A-36	
SQD-160-I (16.000 Nm)	48	30	7000	160A-30	RAH-160
		32	8500	160A-32	
		36	12.000	160A-36	
		41	16.000	160A-41	
		46	16.000	160A-46	
SQD-270-I (27.000 Nm)	59	36	12.000	270A-36	RAH-270
		41	18.000	270A-41	
		46	25.000	270A-46	
		50	27.000	270A-50	
		55	27.000	270A-55	
		60	27.000	270A-60	
		65	27.000	270A-65	
		70	27.000	270A-70	

For SQD Series



Maximum Torque at 800 bar:

27.000 Nm

Allen Drive Range:

14 - 70 mm

Nose Radius:

24 - 59 mm



Optional Allen Drives and Reaction Arm

The RAH-Reaction Arm for Allen drives must be used instead of reaction arm for square drives.



Flange Spreaders

Separates pipe flanges with ease, enabling efficient maintenance tasks.

Page: **66**



Select the Right Torque

Choose your Enerpac Torque Wrench using the loosening torque rule of thumb: Loosening torque may require 250% of tightening torque depending on the condition of the fastener.

▼ SQD-50-I with 50A-22 Allen drive with RAH-50 Reaction Arm for Allen drives.



HI-PRESS HYDRAULICS LTD
RIVERSIDE WORKS,
FORGE ROAD, WHALEY BRIDGE,
HIGH PEAK, SK23 7HY

T: 01663 735089 - F: 01663 735090
sales@hi-press.co.uk

HI-PRESS HYDRAULICS LTD
UNIT 2, HALL HOUSE IND EST,
NEW HUTTON, KENDAL,
CUMBRIA, LA8 0AH

T: 01539 734005 - F: 01539 734006
cumbria@hi-press.co.uk

