



# HI-PRESS HYDRAULICS Ltd

## BRC, BRP-Series, Pull Cylinders



▼ Shown from left to right: BRC-25, BRC-46, BRP-306, BRP-606, BRP-106C



- High strength alloy steel construction
- Hard chrome-plated plunger for long life
- Replaceable links on BRP-models
- Baked enamel finish for increased corrosion resistance
- CR-400 coupler and dust cap included on all models
- Plunger wiper reduces contamination, extending cylinder life
- Single-acting, spring return.

## The Ultimate in Pulling Power



### Gauges

Minimize the risk of overloading and ensure long, dependable service from your equipment. Refer to the

System Components Section for a full range of gauges.

Page: 114



### Attachments and Accessories

BRC-25 and BRC-46 units have base, collar and plunger threads to affix a range of optional attachments and accessories, such as chains, saddles and extension tubes.

Page: 159

▼ Ship building, welding and Enerpac pull cylinders go hand in hand.

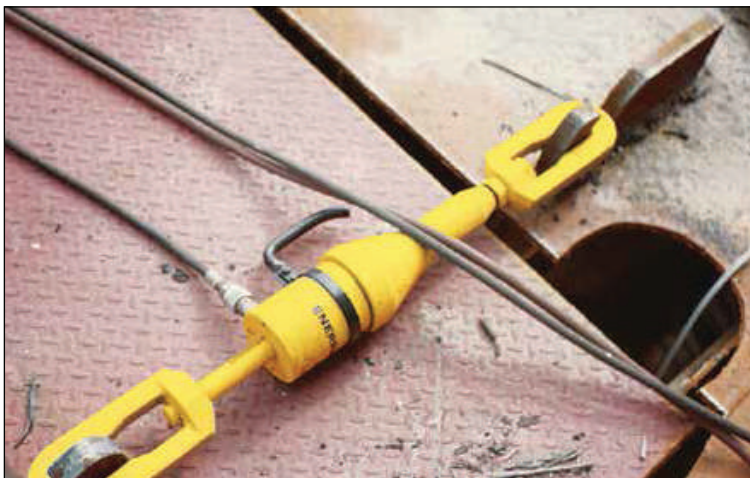

▼ To lift a load bearing mast into place, BRP-series cylinders were used to tension the supporting cables.



HI-PRESS HYDRAULICS LTD  
RIVERSIDE WORKS,  
FORGE ROAD, WHALEY BRIDGE,  
HIGH PEAK, SK23 7HY

T: 01663 735089 - F: 01663 735090  
sales@hi-press.co.uk

HI-PRESS HYDRAULICS LTD  
UNIT 2, HALL HOUSE IND EST,  
NEW HUTTON, KENDAL,  
CUMBRIA, LA8 0AH

T: 01539 734005 - F: 01539 734006  
cumbria@hi-press.co.uk





# HI-PRESS HYDRAULICS Ltd

## Single-Acting, Pull Cylinders



Model Number	Base Mounting Hole V	Collar Thread W	Collar Thd. Lgth. X	Mtg. Thd. Lgth. Z
<b>BRC-25</b>	3/4"-14 NPT	1 1/2"- 16 UN	24	17
<b>BRC-46</b>	1 1/4"-11 1/2 NPT	2 1/4"- 14 UN	26	24
<b>BRC-106</b>	M30 x 2	M85 x 2	25	24

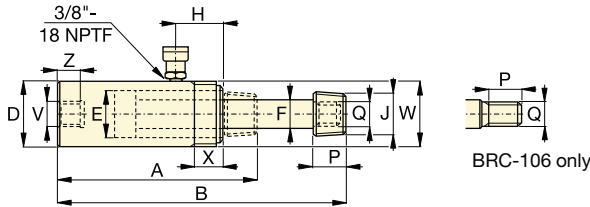

**BRC-25, -46, 106**

### BRC, BRP Series



Capacity:  
**2,5 - 50 ton**

Stroke:  
**127 - 155 mm**

Maximum Operating Pressure:  
**700 bar**

Cylinder Capacity	Stroke	Model Number	Cylinder Effective Area	Oil Capacity	Coll. Height	Ext. Height	Outside Dia.	Cylinder Bore Dia.	Plunger Dia.	Top to Inlet Port	Saddle Diameter	Plunger Thread Length	Plunger Outside Thread	Weight
ton (kN)	(mm)		(cm <sup>2</sup> )	(cm <sup>3</sup> )	A (mm)	B (mm)	D (mm)	E (mm)	F (mm)	H (mm)	J (NPT)	P (mm)	Q	(kg)
<b>2,5 (24)</b>	127	<b>BRC-25</b>	3,5	45	264	391	48	28,4	19,0	45	3/4" - 14	28	1 1/16" - 24	1,8
<b>5 (51)</b>	140	<b>BRC-46</b>	7,3	101	301	441	57	42,9	30,2	42	1 1/4" - 11 1/2	32	1 3/16" - 16	4,5
<b>10 (105)</b>	151	<b>BRC-106</b>	15,0	228	289	440	85	54,1	31,8	39	-	25	M30 x 2	9,5

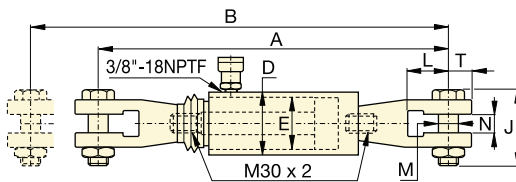

**BRP-106C**

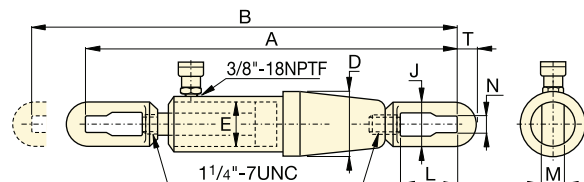

**BRP-306**

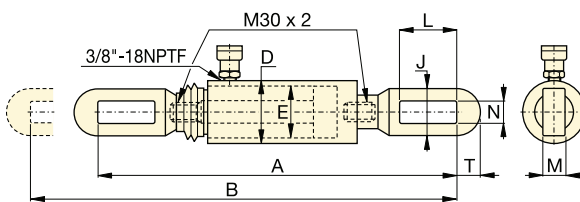

**BRP-106L**

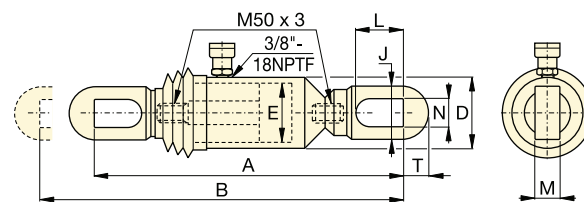

**BRP-606**

Cylinder Capacity	Stroke	Model Number	Cylinder Effective Area	Oil Capacity	Coll. Height	Ext. Height	Outside Dia.	Cyl. Bore Dia.	Link Height	Link Opening	Link Thickness	Link Width	Slot to Link End	Weight
ton (kN)	(mm)		(cm <sup>2</sup> )	(cm <sup>3</sup> )	A (mm)	B (mm)	D (mm)	E (mm)	J (mm)	L (mm)	M (mm)	N (mm)	T (mm)	(kg)
<b>10 (105)</b>	150	<b>BRP-106C</b>	15,0	227	593	743	85	54,1	119	62	30	35	32	15,9
	150	<b>BRP-106L</b>	15,0	227	573	723	85	54,1	67	115	22	30	32	13,2
<b>30 (326)</b>	155	<b>BRP-306</b>	46,6	722	1080	1235	136	88,9	114	145	35	39	50	48,1
<b>50 (505)</b>	152	<b>BRP-606</b>	72,1	1096	716	868	140	110,0	130	149	39	50	70	53,5



**HI-PRESS HYDRAULICS LTD**  
RIVERSIDE WORKS,  
FORGE ROAD, WHALEY BRIDGE,  
HIGH PEAK, SK23 7HY

T: 01663 735089 - F: 01663 735090  
sales@hi-press.co.uk

**HI-PRESS HYDRAULICS LTD**  
UNIT 2, HALL HOUSE IND EST,  
NEW HUTTON, KENDAL,  
CUMBRIA, LA8 0AH

T: 01539 734005 - F: 01539 734006  
cumbria@hi-press.co.uk

