

Hydraulic Combi-tool Cutter-Spreader

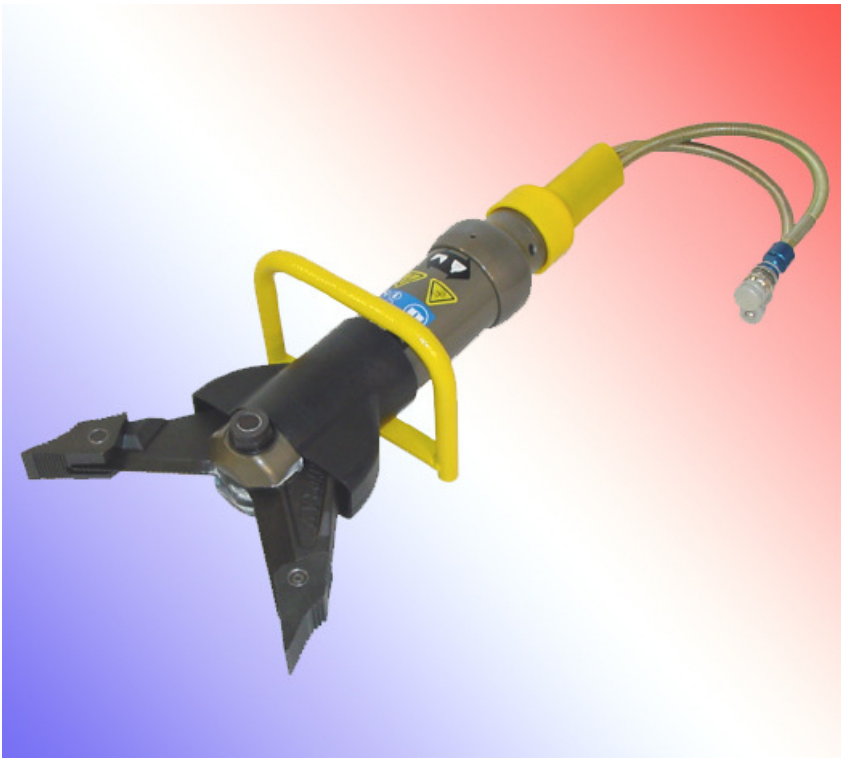

MADE IN FRANCE

▼ Hydraulic combi-tool Cutter-Spreader CHEC 360 et CHEC 3600



The polyvalent combi-tool is designed for rapid intervention

DESCRIPTION

High strength light alloy unit with anti-wear treatment.
Can be used in wet conditions.
The combination hydraulic spreader can cut, spread, pull and crush.

Tool comprises of :

- 1 Double action cylinder.
- 1 Ergonomically shaped control handle with integral safety feature and check valve.
- 1 Set of hoses 0.5m long with automatically locking, anti-pollution, HP quick couplers fitted with metal protection stoppers.
- 2 straight, high strength forged steel blades with anti-corrosion treatment.
- 2 Removable ribbed tips.
- 1 U type holding handle.
- Pressure relief valve for hose on coupler end.

OPTION:

- Chains set **CCMR 2-10 C**

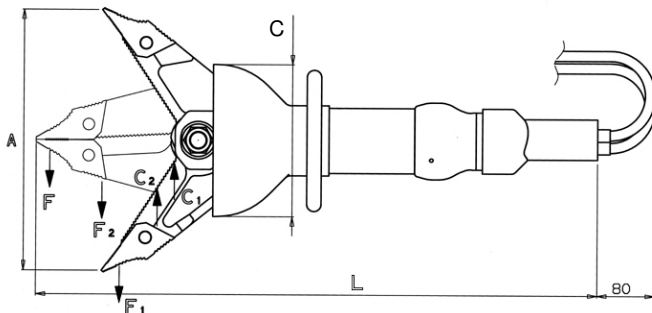

CHARACTERISTICS

Model	CHEC 360	CHEC 3600
Blade type	combinée	combinée
Operating pressure	700 bar	700 bar
Cutting force C1	347 kN	461 kN
Cutting force C2	133 kN	176 kN
Maximum opening (mm) : Côte A	364	364
Spreading force F	40 kN	58 kN
Spreading force F1	27 kN	40 kN
Maximum spreading force F2	54 kN	80 kN
Dimensions (mm)	777x210x165	787x252x195
Weight	15,8 kg	17,8 kg
Tool classification EN 13204	BK 27-365-H/15,8	CK 40-365-H/17,8
Compliance standards	NF - EN - NFPA	NF - EN - NFPA

Powerful, Lightweight and Reliable in Rescue Operations

NO CONTRACTUAL DOCUMENT



Chemin du Lyonnais - 69720 St Bonnet de Mure FRANCE- 33 (0) 4 72 48 90 05 - fax:33 (0) 4 72 48 90 03

Site : www.hydram.com - E-mail : hydram@wanadoo.fr