

▼ From left to right: VLP-506ZE5S, VLP-1006ZE3S, VLP-106P142, VLP256PAT1



- Quality welded frame for maximum strength and stability
- Optimum daylight and bed width
- With hand pump, air or electric driven power source
- Single or double-acting GOLDEN RING DESIGN cylinders
- Standard glycerine filled gauge with scale reading in kN/bar
- Moveable pump table on presses with electric pump allows for easy side loading for large workpieces
- Height adjustment of lower bed on 25 ton press with a winch
- Unique "Hydrajust" bed positioning device on 50, 100 and 200 ton press with double-acting cylinder allows adjustment of the lower bed

No Workshop can do without one



Optional V-Blocks

To facilitate positioning of pipes and bars, or placed upside-down, to serve as a convenient worktable.

Featuring precise fit into the press bolster. Each model number includes two V-blocks.

To be used with VLP-press ton	V-Blocks Model Number
10	VB-10
25	VB-25
50	VB-501
100	VB-101
200	A-200

Page: 150



Centered Manual Valves

Manual 3-position valves on electric pumps supplied on VLP-Series presses automatically move to the

tandem centre position for safety reasons.

▼ SELECTION CHART

Press Capacity ton (kN)	Maximum Daylight (mm)		Press Model Number	Power Source						Cylinder						
	Vertical	Horizontal		Pump Type			Valve Type			Pump Model Nr.	Page:			Stroke (mm)	Cylinder Model Nr.	Page:
				Man.	Elec.	Air	Man.	Elec.								
10 (101)	430	432	VLP-106P142	•			•			P-142	68	•		155	RC-106	8
	430	432	VLP-106PAT1			•	•			PATG-1102N	98	•		155	RC-106	8
25 (232)	1225	510	VLP-256P392	•			•			P-392	68	•		159	RC-256	8
	1225	510	VLP-256PAT1			•	•			PATG-1102N	98	•		159	RC-256	8
50 (498)	994	1000	VLP-506P802	•			•			P-802	70	•		159	RC-506	8
	994	1000	VLP-506ZE5S		•			•		ZE5410SW-S	90		•	155	RR-506	34
	994	1000	VLP-506ZE5C		•			•		ZE5410CW-S	90		•	155	RR-506	34
	994	1000	VLP-5013ZE5S		•			•		ZE5410SW-S	90		•	333	RR-5013	34
100 (933)	989	1000	VLP-1006ZE3C		•			•		ZE3410CW	90		•	168	RR-1006	34
	989	1000	VLP-1006ZE3S		•			•		ZE3410SW	90		•	168	RR-1006	34
	989	1000	VLP-10013ZE3S		•			•		ZE3410SW	90		•	333	RR-10013	34
200 ¹⁾	1340	1220	VLP-20013ZE4S		•			•		ZE4420SW	90		•	333	RR-20013	34

¹⁾ 1995 kN



= Single-Acting



= Double-Acting

Bench and Workshop Presses



Press Gauges

All presses include a gauge and gauge adaptor, matching the press capacity.

Press Capacity ton	Gauge Model Number	Adaptor Model Number
10	GF-10B	GA-4
25	GF-20B	GA-2
50	GF-50B	GA-2
100	GF-871B	GA-3
200	GF-200B	GA-3

Page: 128



"Hydrajust" Bed Positioning

Allows vertical adjustment of the lower bed on the 50, 100 and 200 ton VLP press.



The "Hydrajust" bed positioning is not designed to withstand full cylinder capacity, only to be used for bed adjustment.

Page: 150

VLP Series



Capacity:

10 - 200 ton

Maximum Daylight x Width:

1340 x 1220 mm

Maximum Operating Pressure:

700 bar



IMPORTANT! The frameworks of the workshop presses are exclusively designed for pressing operations, not for pulling. For pulling applications please contact Enerpac.

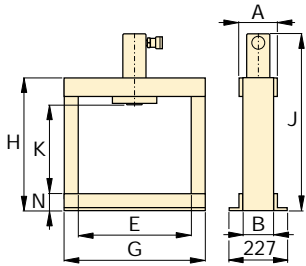

VLP 10 ton Bench

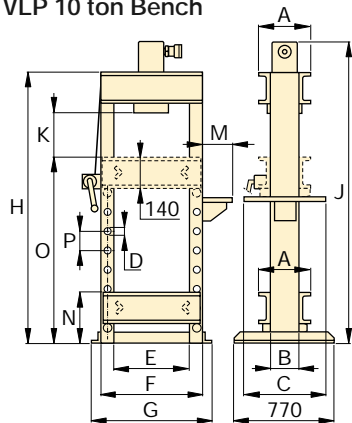

VLP 25 ton

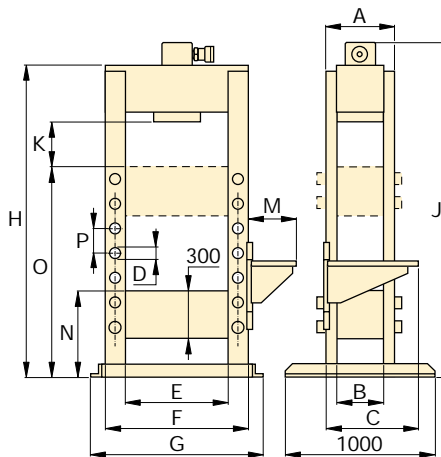

VLP 50 and 100 ton

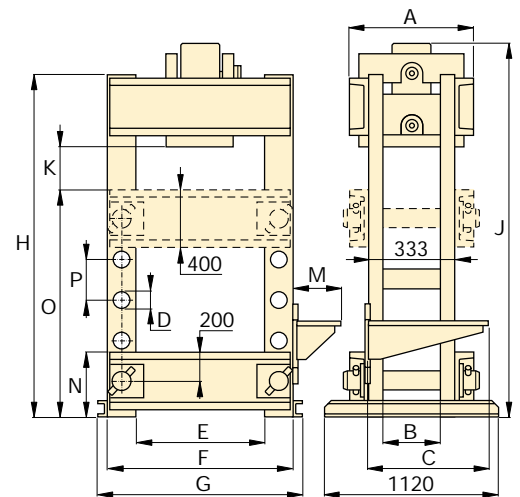

VLP 200 ton

Speed (mm/sec)*		Dimensions (mm)															Press Model Number
Rapid Advance	Pressing	A	B	C	D	E	F	G	H	J	K	M	N	O	P	(kg)	
{2,5}*	{0,6}*	110	80	-	-	432	-	542	620	748	430	-	80	-	-	49	VLP-106P142
10,0	1,8	110	80	-	-	432	-	542	620	748	430	-	80	-	-	54	VLP-106PAT1
{3,4}*	{0,7}*	260	140	510	32	510	630	700	1622	1740	370	140	212	1070	122	165	VLP-256P392
5,0	0,8	260	140	610	32	510	630	700	1622	1740	370	323	212	1070	122	161	VLP-256PAT1
{5,5}*	{0,3}*	290	250	560	32	990	1200	1360	1879	1879	244	425	540	1290	150	595	VLP-506P802
4,1	3,9	290	250	560	32	990	1200	1360	1879	1879	244	425	540	1290	150	675	VLP-506ZE5S
4,1	3,9	290	250	560	32	990	1200	1360	1879	1879	244	425	540	1290	150	660	VLP-506ZE5C
4,1	3,9	290	250	560	32	990	1200	1360	1879	2042	244	425	540	1290	150	700	VLP-5013ZE5S
7,7	0,7	400	340	560	40	990	1240	1400	1879	1885	239	425	540	1290	150	962	VLP-1006ZE3C
7,7	0,7	400	340	560	40	990	1240	1400	1879	1885	239	425	540	1290	150	970	VLP-1006ZE3S
7,7	0,7	400	340	560	40	990	1240	1400	1879	2050	239	425	540	1290	150	993	VLP-10013ZE3S
5,2	0,5	553	233	560	76	1220	1620	1740	2285	2370	377	425	453	1415	254	1992	VLP-20013ZE4S

* {...} = advance speed in mm per handpump stroke.