

# Hydraulic Machine Lifts

▼ Shown from left to right: SOH-10-6, SOH-23-6



## SOH Series

Lifting Capacity:

**8.5-20 tons**

Stroke:

**5.39-6.18 inches**

Toe Clearance:

**0.79-1.18 inches**

Maximum Operating Pressure:

**10,000 psi**



### RSM Flat-Jac®

Low height, single acting spring-return cylinders are ideal for space restricted applications.

Page: 22



### Best Match Manual Pump

To power your Enerpac Lifting Wedge, The Enerpac P-392 Hand Pump or P-392FP Foot Pump is an ideal choice.

Page: 61

- For lifting heavy equipment with minimum available access
- Remote operation of hydraulic pump enhances safety
- Low-height lifting toe
- Precision guided to reduce friction and isolate cylinder from side-loads
- Two extendable support feet provide extra stability
- Includes RC-Series cylinder with CR-400 coupler

▼ Limited access under this machine makes the Enerpac Hydraulic Machine Lift the perfect solution.

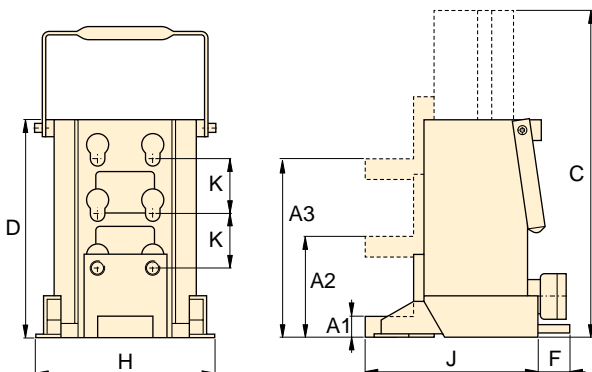

Capacity (ton)	Toe Clearance with Cylinder Retracted (in)			Stroke (in)	Model Number	Oil Capacity (in <sup>3</sup> )	Dimensions (in)						Weight (lbs)
	Minimum A1	Central A2	Maximum A3				Total Ext. Height C	Total Body Height D	F	H	J	K	
	<b>8.5</b>	.79	3.74				6.69	5.39	<b>SOH-10-6</b>	13.7	17.00	11.61	
<b>20</b>	1.18	4.33	7.48	6.18	<b>SOH-23-6</b>	32.0	18.58	12.40	2.56	10.24	9.84	3.15	99.2