

▼ Shown left to right: GA-3, V-91, GA-1, GA-2, GA-4, NV-251, GA-918



GA, NV, V Series

Operating Pressure:

10,000 psi

▼ A gauge is easily installed into your hydraulic system using a gauge adaptor.



Gauge Adaptors (GA-Series)

- For easy mounting of a pressure gauge into your system
- Male end screws into pump or cylinder port, female end accepts hose or coupler, third port is for gauge connection
- GA-918 provides for swivel connection
- Simplifies gauge installation and reading

Model Number	Gauge Port (NPTF)	Male End (NPTF)	Female End (NPTF)	Dimensions (in)					
				A	B	C	D	E	F
GA-1	1/2	3/8	3/8	2.81	1.24	1/2 NPTF	3/8 NPTF	3/8 NPTF	1.25
GA-2	1/2	3/8		6.10	1.38	1/2 NPTF	3/8 NPTF	3/8 NPTF	1.25
GA-3	1/4	3/8		5.25	1.38	1/4 NPTF	3/8 NPTF	3/8 NPTF	1.25
GA-4	1/2	1/4		4.38	1.38	1/2 NPTF	1/4 NPTF	3/8 NPTF	1.25

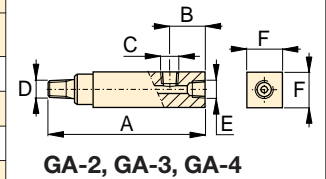
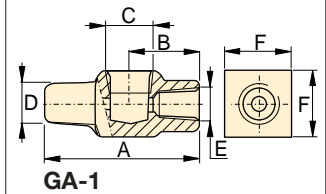

Swivel Adaptor (GA-918)

- Simplifies gauge installation and reading

Model Number	Dimensions (in)						
	A	B	C	D	E	S	S1
GA-918	4.62	1.72	1/2 NPTF	1.30	1/2 NPTF	1.13	1.50

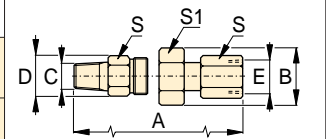

Needle Valves (NV- and V-Series)

- Both NV-251 and V-91 provide positive shut-off
- 316 stainless steel stem, 24 threads/in

Model Number	Orifice	Thread Size	Dimensions (in)						
			A	B	C	D	E	F	G
NV-251	.17	1/4" NPT	2.22	.75	.38	1.81	2.25	1.13	.72
V-91	.19	1/2" NPT	3.50	1.44	.63	1.25	2.50	1.25	-

